



**COMMONWEALTH OF KENTUCKY
TRANSPORTATION CABINET**
Frankfort, Kentucky 40622
www.transportation.ky.gov/

Matthew G. Bevin
Governor

Greg Thomas
Secretary

July 24, 2017

CALL NO. 306
CONTRACT ID NO. 171223
ADDENDUM # 1

Subject: Barren County, FD04 SPP 055 NEW ROUTE
Letting July 28, 2017

(1) Revised - Plans - R2C & R6

Proposal revisions are available at <http://transportation.ky.gov/Construction-Procurement/>.

Plan revisions are available at <http://www.lynnimaging.com/kytransportation/>.

If you have any questions, please contact us at 502-564-3500.

Sincerely,

A handwritten signature in cursive script that reads "Rachel Mills".

Rachel Mills, P.E.
Director
Division of Construction Procurement

RM:ks
Enclosures



An Equal Opportunity Employer M/F/D

CONC
 CLASS A CONCR
 APPENDUM - CLASS A CONCR
 CABINET 7-21-2017
 TRANSPORTATION CABINET 7-21-2017
 BARRENS CALVARY 3-8705 DELIVERABLES
 FILE NAME: Y:\NYTC 2013\213-220 SMDRWY.BARREN CALVARY 3-8705\DELIVERABLES\SENT TO TRANSPORTATION CABINET 7-21-2017
 USER: Ibrrown
 DATE PLOTTED: July 24, 2017
 E-SHEET NAME:
 MicroStation v8.11.9.829

CONST. HEADER CURB LT.			
STA. TO STA.	CURB TYPE	LENGTH	SAW CUT
45+90 - 49+20	STD. HEADER	330 L.F.	330 L.F.

CHAIN LINK FENCE			
LT/RT	FROM STATION	TO STATION	LIN FT
LT.	49+16	49+26	10

P
102
GLASGOW
CHRISTIAN
ACADEMY, INC.

DITCH CONSTRUCTION LT. US 31E					
STA. TO STA.	SIZE/TYPE	LENGTH	CHANNEL LINING		
			TYPE	D	T QUANTITY
48+40 - 48+90	SPCL. 'V' DT.	50 FT	ECB 1.5	-	38 SQ. YDS
48+90 - 49+30	SPCL. 'V' DT.	40 FT	CL II 1.5	-	19 TONS
50+39 - 50+60	SPCL. 'V' DT.	21 FT	CL III 1.0	-	15 TONS

I.D.	BEARING	DISTANCE
A	S66°50'53"E	36.55'
B	N50°47'34"E	32.38'

COUNTY OF	ITEM NO.	SHEET NO.
BARREN	3-8705.00	R6

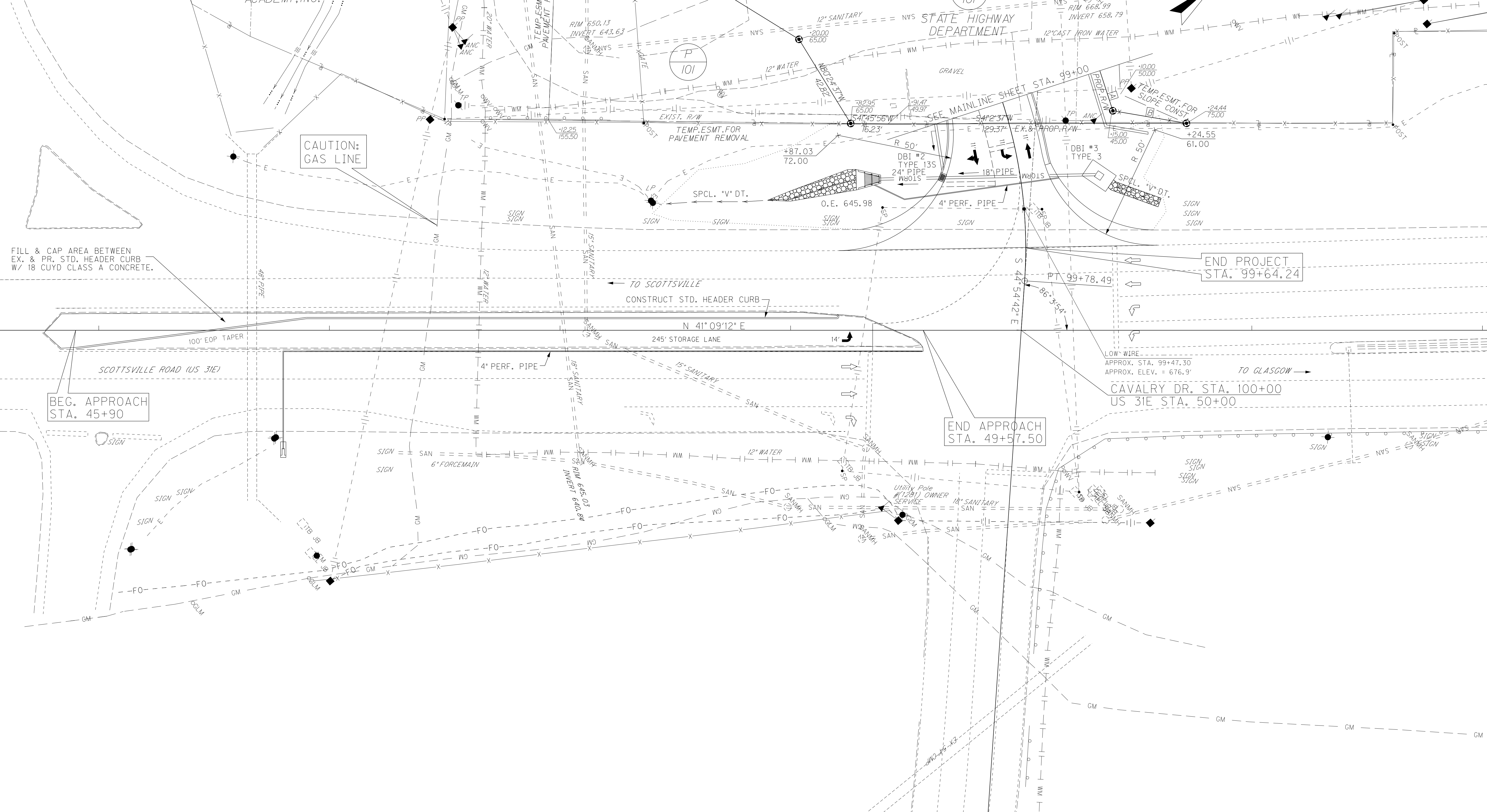

EDGE DRAIN CONSTRUCTION RT.				
STA. TO STA.	4\"/>			
46+80 - 49+57	277'	39'	3	-

* TO BE CONSTRUCTED BY OPEN CUTTING THE EXISTING ROADWAY

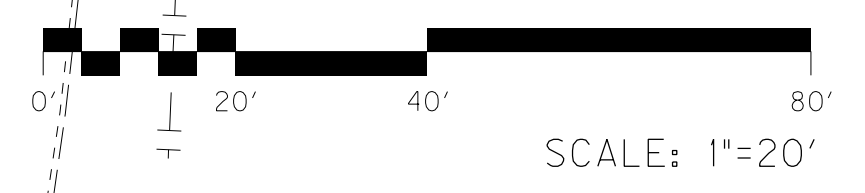

US 31E
 PLAN
 STA. 45+90 TO STA. 49+57.50

CONTRACT NO. 3-8705 DELIVERABLES SENT TO TRANSPORTATION CABINET 7-21-2017 APPENDUM - CLASS A CONSTRUCTION
 FILE NAME: Y:\NYTC\2013\213-220 SMDRWY.BARREN CALVARY.3-8705\DELIVERABLES\SENT TO TRANSPORTATION CABINET 7-21-2017 APPENDUM - CLASS A CONSTRUCTION
 USER: Ibrrown
 DATE PLOTTED: July 24, 2017
 E-SHEET NAME:
 MicroStation v8.11.9.829

CONST. HEADER CURB LT.			
STA. TO STA.	CURB TYPE	LENGTH	SAW CUT
45+90 - 49+20	STD. HEADER	330 L.F.	330 L.F.

CHAIN LINK FENCE			
LT/RT	FROM STATION	TO STATION	LIN FT
LT.	49+16	49+26	10

P
102
GLASGOW
CHRISTIAN
ACADEMY, INC.

DITCH CONSTRUCTION LT. US 31E				
STA. TO STA.	SIZE/TYPE	LENGTH	CHANNEL LINING	QUANTITY
48+40 - 48+90	SPCL. 'V' DT.	50 FT	ECB 1.5	38 SQ. YDS
48+90 - 49+30	SPCL. 'V' DT.	40 FT	CL II 1.5	19 TONS
50+39 - 50+60	SPCL. 'V' DT.	21 FT	CL III 1.0	15 TONS

I.D.	BEARING	DISTANCE
A	S66°50'53"E	36.55'
B	N50°47'34"E	32.38'

COUNTY OF	ITEM NO.	SHEET NO.
BARREN	3-8705.00	R6

REVISED 7-21-2017

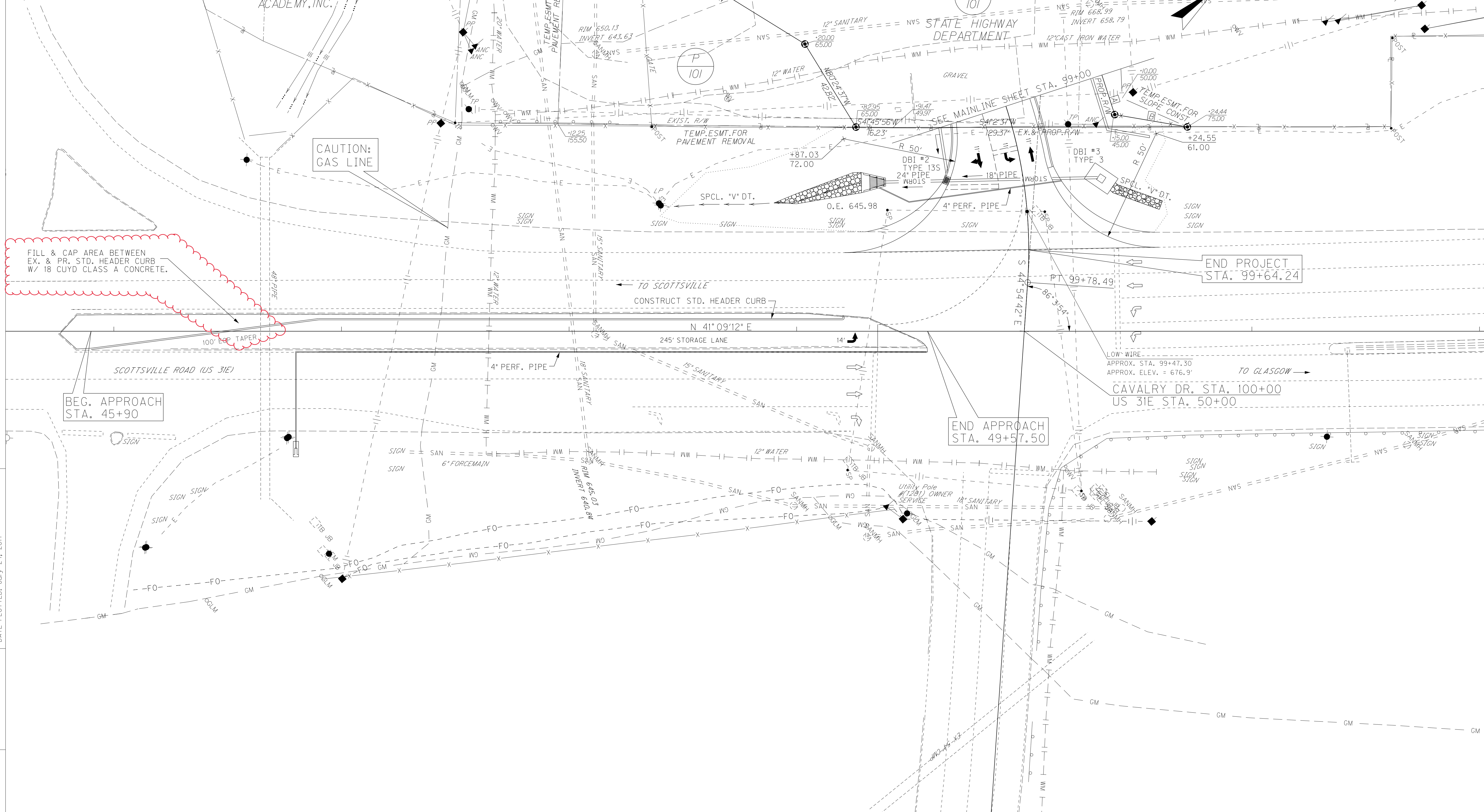

EDGE DRAIN CONSTRUCTION RT.				
STA. TO STA.	4\"/>			
46+80 - 49+57	277'	39'	3	-

* TO BE CONSTRUCTED BY OPEN CUTTING THE EXISTING ROADWAY



US 31E
PLAN
STA. 45+90 TO STA. 49+57.50